

Toscana at West Creek

SITE PLAN

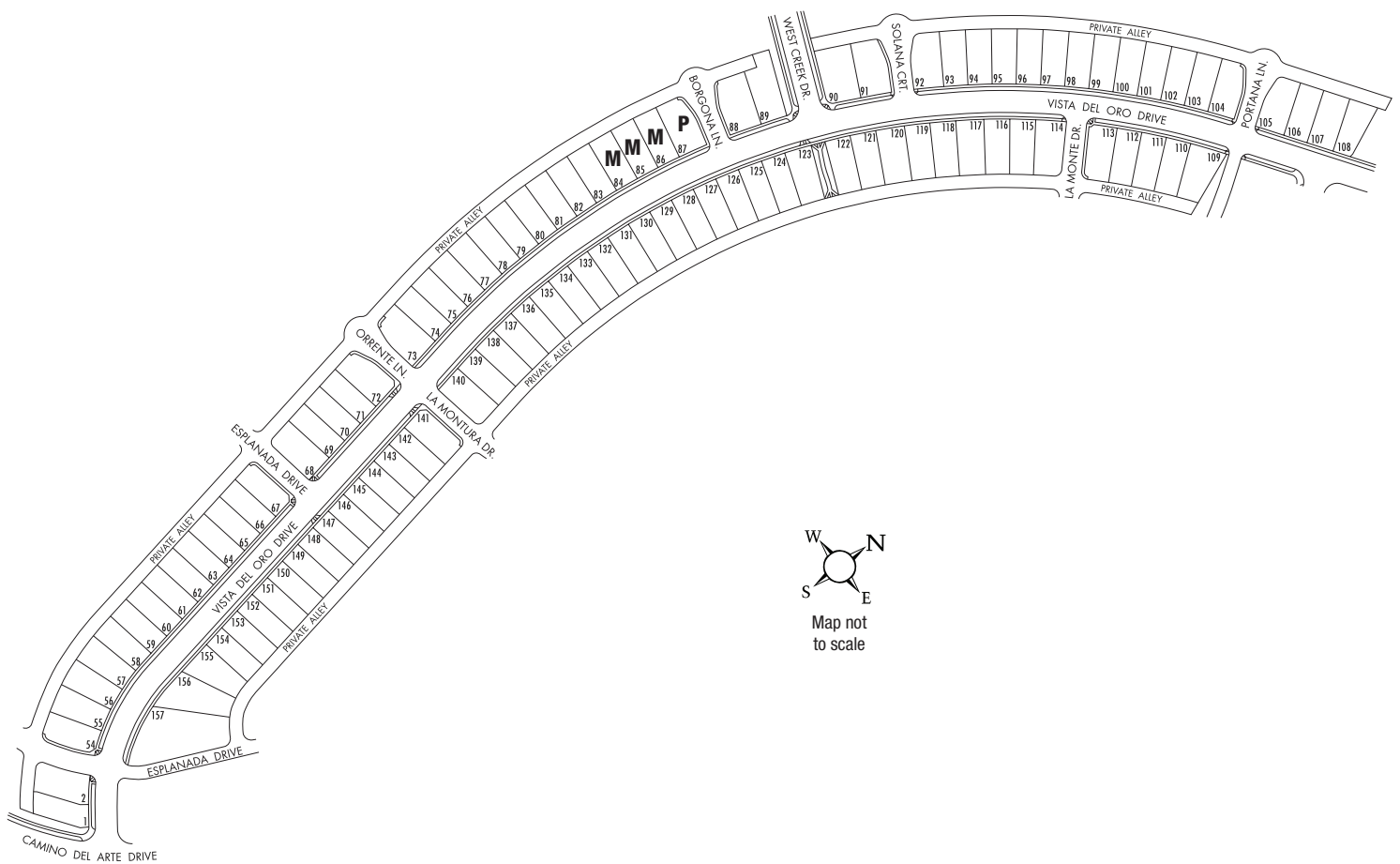

LENNAR.COM

Toscana at West Creek • 28553 Vista Del Rio Drive, Valencia CA 91354 • 888-214-9408

Site plans and community maps are conceptual in nature and are merely an artist's rendition. These maps are solely for illustrative purposes and should never be relied upon. THE PAST, PRESENT, FUTURE OR PROPOSED ROADS, EASEMENTS, LAND USES, CONDITIONS, PLAT MAPS, LOT SIZES OR LAYOUTS, ZONING, UTILITIES, DRAINAGE, LAND CONDITIONS, OR DEVELOPMENT OF ANY TYPE WHATSOEVER, WHETHER REFLECTED ON THE SITE PLAN OR MAP, OR WHETHER OUTSIDE THE BOUNDARIES OF THE SITE PLAN OR MAP, MAY NOT BE SHOWN OR MAY BE INCOMPLETE OR INACCURATE. THE PRESENT, FUTURE OR PROPOSED ROADS, EASEMENTS, LAND USES, CONDITIONS, PLAT MAPS, LOT SIZES OR LAYOUTS, ZONING, DRAINAGE, LAND CONDITIONS, OR DEVELOPMENT OF ANY TYPE MAY OR MAY NOT CHANGE IN THE FUTURE. IT IS NOT UNCOMMON THAT ANY OF THE FOREGOING CAN CHANGE WITHOUT NOTICE TO YOU. YOU SHOULD NEVER RELY ON THE ACCURACY OF THIS MAP IN MAKING ANY DECISIONS RELATIVE TO PURCHASING ANY PROPERTY. We reserve the right to make changes at any time without notice. Copyright © 2013 Lennar Corporation. Lennar and the Lennar logo are registered service marks of Lennar Corporation and/or its subsidiaries. Lennar Homes of California, Inc. License #728102. Lennar Sales Corp. - DRE License #01252753. 02/13

